



# HC14gPV 1500V DC 1A-15A Photovoltaic Fuse 光伏熔断器



Standard/ IEC 60269-6, GB/T 13539.6, UL 248-19

INTERRUPTING CAPACITY /  
30,000 A at 1500V DC

Dimensions/ : Unit 单位: mm

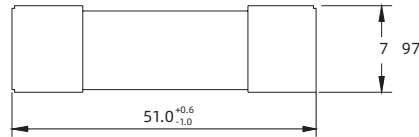

TECHNICAL PARAMETERS/ :

PART NO. 目录编号	CURRENT RATING 额定电流	SAFETY APPROVALS 安全认证	
		TUV	cULus
14gPV1U15	1A	○	●
14gPV2U15	2A	○	●
14gPV2.5U15	2.5A	○	●
14gPV3U15	3A	○	●
14gPV3.5U15	3.5A	○	●
14gPV4U15	4A	○	●
14gPV5U15	5A	●	●
14gPV6U15	6A	●	●
14gPV8U15	8A	●	●
14gPV10U15	10A	●	●
14gPV12U15	12A	●	●
14gPV15U15	15A	●	●

U15 DENOTES FOR 1500V DC U15 表示 1500V DC  
 ● DENOTES FOR APPROVAL ● 表示已取得安全认证  
 ○ DENOTES FOR PENDING ○ 表示正在申请安全认证

Recommended fuse-base for 14.3mmx51mm fuses

See Model of product: HC141B HF-141A

适用于 14.3mmx51mm 熔断体的支持件

详见产品型号: HC141B HF-141A

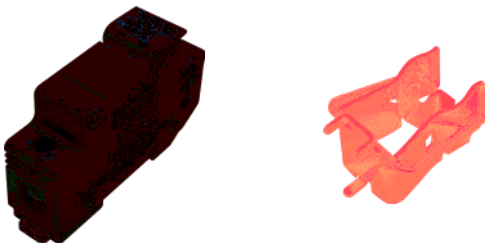

ELECTRICAL CHARACTERISTICS/ :

% of CURRENT RATING 额定电流的 %	BLOWING TIME 熔断时间
113%	1 hour Min. 最快 1 小时
135%	1 hour Max. 最慢 1 小时
145%	1 hour Max. 最慢 1 小时

HC14gPV 1500V 平均 I-T 曲线图 (仅供参考)

AVERAGE I-T CHARACTERISTICS CURVE  
(FOR REFERENCE ONLY)

